

QUICK GUIDE

Connecting your PTT Voice Responder to MOTOTALK (Android) (EN)



A

Pairing your PTT Voice Responder with your smartphone via Bluetooth

1. Turn on your PTT Voice Responder by holding down the Power button for more than 3 seconds. After it is on, a blinking green light will indicate that the device is ready for pairing.
2. Turn on your smartphone's Bluetooth by going to: Settings → Bluetooth → Turn on.
3. Pair your PTT Voice Responder to your smartphone by selecting it from the 'Available devices' list. To know which device to select from the list, check the unique friendly name on the back of your Voice Responder. Once it has successfully paired, a blue light will begin blinking on your device.

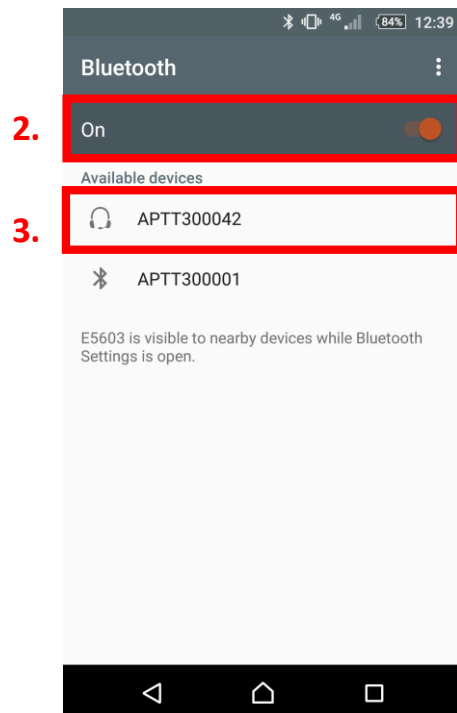

NOTE: The Voice Responder can only be paired with one device at a time. If you want to pair it to another device you need to perform an **Unpairing/ Software reset** by pressing and holding both soft buttons and both PTT buttons simultaneously, until the LED blinks once in yellow.



B

Enabling your PTT Voice Responder within MOTOTALK

1. In the MOTOTALK application, select the three horizontal lines on the top left corner.
2. Then select 'Settings'.
3. From the list that appears, select 'PTT Voice Responder'.
4. Activate this feature for the application to connect to your PTT Voice Responder.

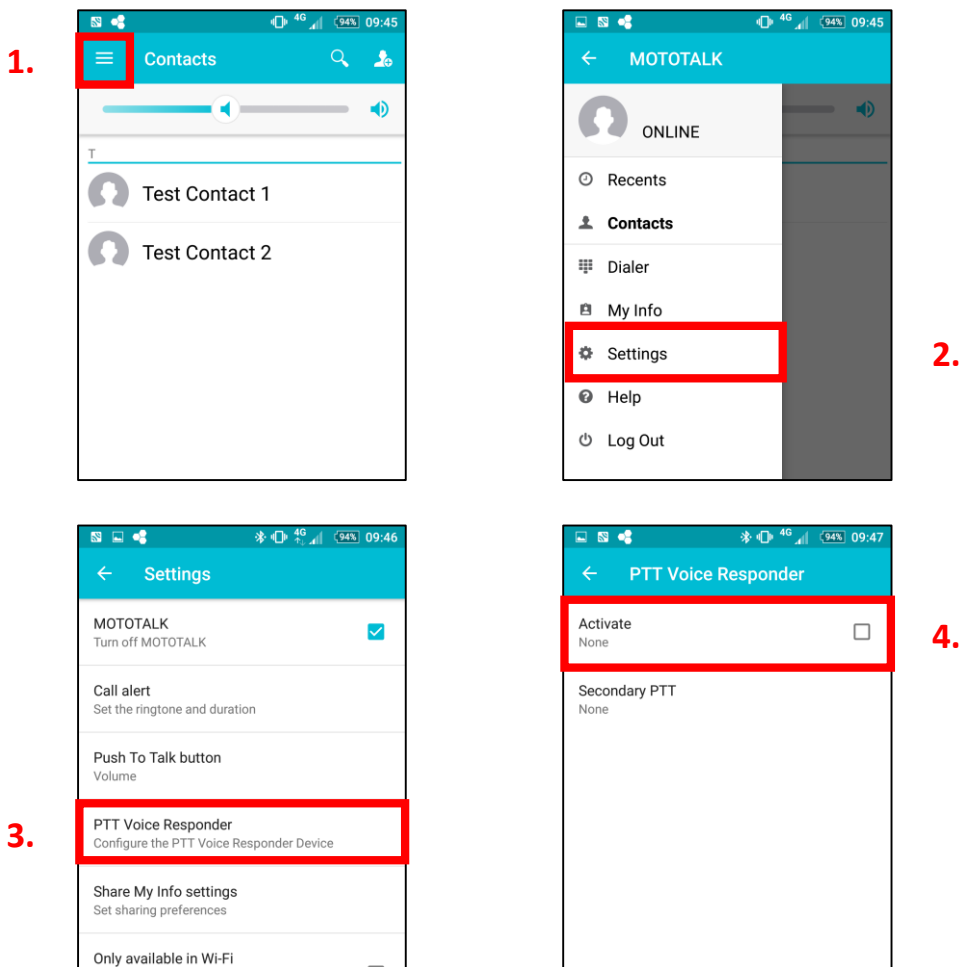

If the application cannot find your PTT Voice Responder, make sure that your Voice Responder is still connected to your smartphone via Bluetooth (the LED should be blinking in blue). If it is not, perform part A again.



Enabling the Secondary PTT Button within MOTOTALK

1. In the MOTOTALK application, select the three horizontal lines on the top left corner.
2. Then select 'Settings'.
3. From the list that appears, select 'PTT Voice Responder'.
4. Select 'Secondary PTT'.
5. Select 'Contacts'.
6. From the list that appears, select a user that you would like to contact every time you press the secondary PTT button.

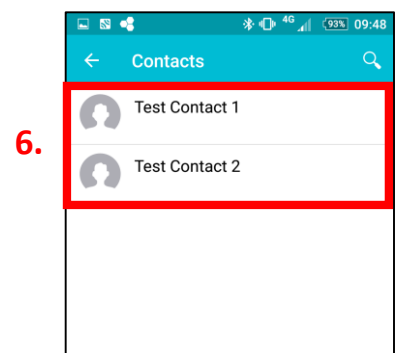
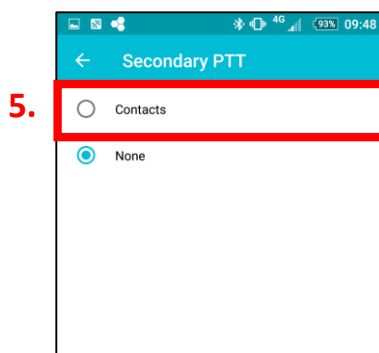
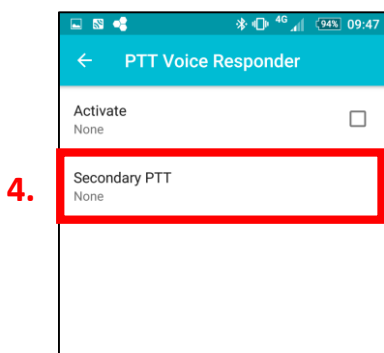
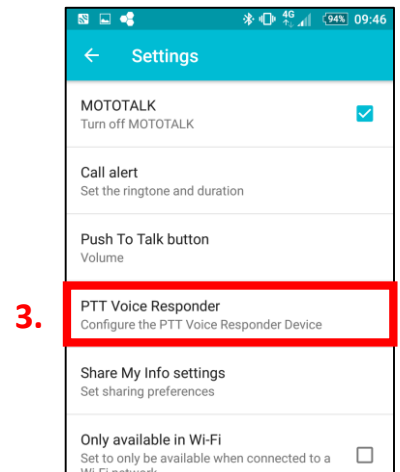
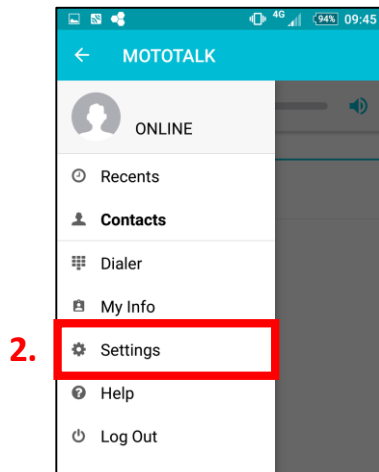
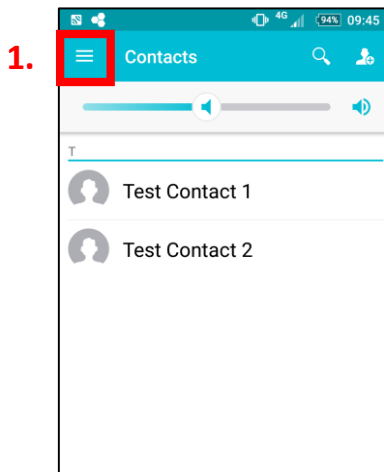

AINA PTT Voice Responder's main button functions when connected to MOTOTALK



| Button | Function |
|-----------------------|--|
| Power ON/ OFF | Press for more than 3 seconds to turn the device on/off. |
| Primary PTT | Press and hold to speak. Release when you are done. |
| Secondary PTT | Press to communicate with a pre-assigned contact (the secondary PTT must be configured within application's settings). |
| Emergency | Press to send an alert to another user. |
| Volume buttons | Press and hold to increase/ decrease the speaker's volume. |
| Soft buttons | These buttons have multiple functions: <ul style="list-style-type: none"> • Press and hold the left soft button to (de)activate the LED. • Press and hold both soft buttons to (de)activate Covert Mode in which LED indications are suppressed and audio annunciations are only delivered through a headset. |

Visit www.aina-wireless.com to find additional accessories, an extended user manual of the AINA PTT Voice Responder and more user guides. If you have any further questions, you can also email us at: info@aina-wireless.com

